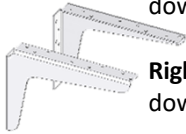

# Gambas Workstation Brackets

<p align="center"><b><u>Applications</u></b></p> <p>Countertops      Desktops</p> <p>Heavy Duty Shelving Units</p> <p>Tabletop          Workstations</p>	 	<p align="center"><b><u>Specifications</u></b></p> <p>11 Gauge Steel (1/8" thick)</p> <p>Weight Limit Exceeds 1000 lbs/pair</p> <p>1 1/2" Forms with 1/4" Holes</p>
--	---	---

<p align="center"><b><u>Standard Quantities</u></b></p> <p>24" x 28", 18" x 24", and 15" x 15" come in 6 brackets/box (3 left, 3 right)</p> <p>8" x 12" brackets come in 10 brackets/box (5 right, 5 left)</p>	 <p><b>Left:</b> with the short side pointing down, the flange is to the left.</p> <p><b>Right:</b> With the short side pointing down, the flange is to the right.</p>
--	--

**Three Standard Sizes**

There are three standard sizes that are offered as diagrammed below. Should the application require a different size, we do offer custom fabrication sizes from 6" x 6" to 36" x 36" as well as metal thicknesses between 1/16" and 3/8".

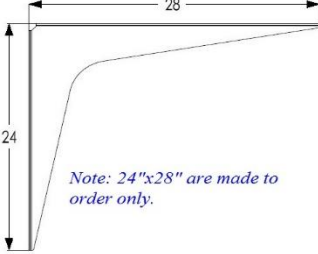

*Note: 24"x28" are made to order only.*

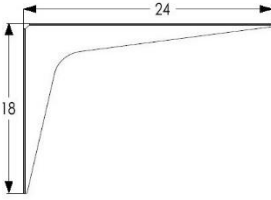

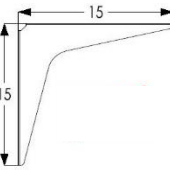

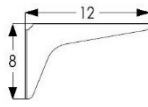





*Note: 8"x12" are only available in standard mount.*

## **Bracket Standard Colors**

Black Crinkle (BK)	Pearl (PL) (Uni-Cream)	White Peel (WP)	Folkstone Gray (FG)
			

## **Standard Mounting Styles**

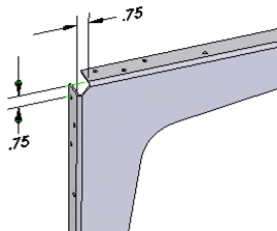

**Standard (S)**

3/4" x 3/4" Bevel

Standard Mount – This is used when there are no requirements for routing between the bracket and the mount on the wall.

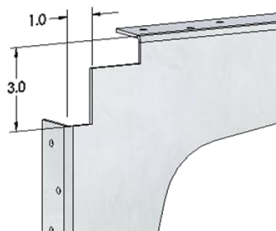

**Cleat Mount (C)**

(2) 1" x 3" Knockouts

Cleat Mount – Plywood Cleat is used for tabletop support clearance to provide stability of the tabletop material.

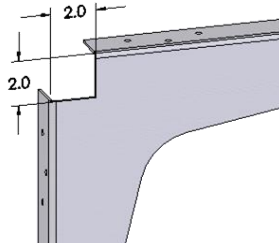

**Wire Management (W)**

2" x 2" Knockouts

Wire Management Mount – This cutout is beneficial for routing wire underneath the mounting surface for a clean installation.

## **Optional Mounting**

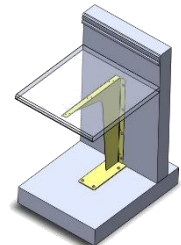

**Foot-Mounted**

In addition to our custom brackets, we offer a customizable foot-mounted bracket which can be used for 1/2 wall or non-structural wall applications.